

(Special) Service tools for ROTAX® Aircraft Engines

ATA System: 00-00-00 Service tools

1) Planning information

“PAC” Service Instruction Documents provide detailed information on ROTAX® Aircraft Engine Parts and Accessories. Depending on the engine type used with, the referenced parts and accessories may be provided with or without EASA certification or ASTM compliance. Certification / Compliance of referenced Parts and Accessories must in such cases be completed by the aircraft OEM.

To obtain satisfactory results, procedures specified in this publication must be accomplished with accepted methods in accordance with prevailing legal regulations.

BRP-Rotax GmbH & Co KG cannot accept any responsibility for the quality of work performed in accomplishing the requirements of this publication.

1.1) Applicability

Refer to the latest issue of the relevant Illustrated Parts Catalog and/or Maintenance Manuals of your specific engine type.

1.2) Concurrent ASB/SB/SI and SL

None.

1.3) Reason

In the course of product maintenance and expansion of our spare parts and special tools program, optional special tools are available.

1.4) Subject

(Special) Service tools for ROTAX® Aircraft Engines.

1.5) Compliance

None - For Information Only.

1.6) Approval

None.

1.7) Labor time

Estimated labor hours:

Engine installed in the aircraft - - - labor time will depend on airframe installation and therefore no estimate is available from the engine manufacturer.

1.8) Mass data

Change of weight - - - none.

Moment of inertia - - - unaffected.

1.9) Electrical load data

No change.

1.10) Software modifications

No change.

SERVICE INSTRUCTION - PAC

1.11) References

In addition to this technical information refer to current issue of

- Illustrated Parts Catalog (IPC)
- Installation Manual (IM)
- Maintenance Manual Line (MML)
- Maintenance Manual Heavy (MMH)

NOTE: The status of the Manuals can be determined by checking the table of amendments. The 1st column of this table shows the revision status. Compare this number to the one listed on the ROTAX website:
www.flyrotax.com. Updates and current revisions can be downloaded for free.

1.12) Other Publications affected

None.

1.13) Interchangeability of parts

- All parts are interchangeable

SERVICE INSTRUCTION - PAC

2) Material Information

2.1) Material- cost and availability

Price and availability will be provided on request by ROTAX® Authorized Distributors or their independent Service Centers.

2.2) Company support information

- Any possible support by BRP-Rotax will be provided on request by ROTAX® Authorized Distributors or their independent Service Centers.

2.3) iRMT training requirements

Each special tool or device is listed with the iRMT training requirement necessary to perform the work for which the tool is intended.

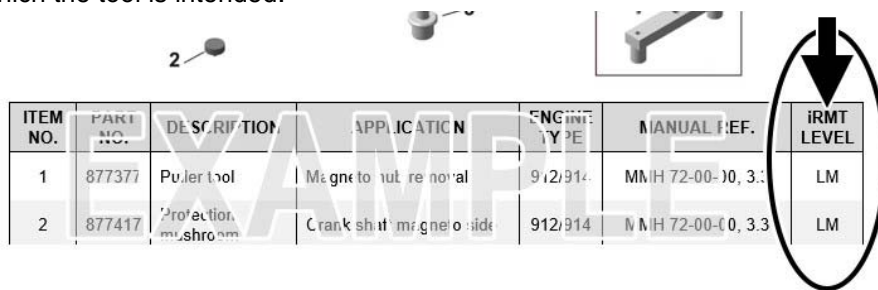

ITEM NO.	PART NO.	DESCRIPTION	APPLICATION	ENGINE TYPE	MANUAL REF.	iRMT LEVEL
1	877377	Puller tool	Magnet nut removal	912/914	MMH 72-00-00, 3.3	LM
2	877417	Protection mushroom	Crankshaft magnet side	912/914	MMH 72-00-00, 3.3	LM

Fig. 1

10356

2.4) Material requirement per spare part

None.

2.5) Rework of parts

None.

2.6) Special tooling/lubricants- /adhesives- /sealing compounds



Fig. 2

10357

Item no.	Part no.	Description	Application	Engine type	Manual ref.	iRMT level
1	276275	276270 + packaging	Oil filter inspection	all	MML 12-20-00	LM
	276270	Oil filter cutting tool				

d06867.fm

SERVICE INSTRUCTION - PAC

3) Accomplishment/Instructions

- ROTAX reserves the right to make any amendments to existing documents which might become necessary due to this standardization, at the time of next revision or issue.

NOTE: Before maintenance, review the entire documentation to make sure you have a complete understanding of the procedure and requirements.

Accomplishment

All measures must be implemented and confirmed by at least one of the following persons or organizations:

- ROTAX® - Authorized Distributors or their independent Service Centers
- Persons with approved qualifications for the corresponding engine types. Only authorized persons (iRMT, Level (minimum) Line Maintenance) are entitled to carry out this work.

NOTE: All work has to be performed in accordance with the relevant Maintenance Manual.

General

All general inspection, maintenance and repair has to be carried out e.g. in accordance with relevant Advisory Circular AC 43.13 from FAA.

Advisory Circular

This Manual "Advisory Circular" AC describes maintenance methods, techniques and practice. These are recognized and authorized for inspection and repairs in non-pressurized areas for which there are no separate maintenance and repair instructions.

3.1) Spare Parts - related information



See current Illustrated Parts Catalog (IPC) for the respective engine type.

3.2) Operation - related information



See current Operators Manual (OM) for the respective engine type.

3.3) Installation - related information



See current Installation Manual (IM) for the respective engine type.

3.4) Maintenance (Line) - related information

3.4.1) Oil filter cutting tool



See current Maintenance Manual Line (MML) for the respective engine type for scheduled maintenance checks, such as oil change and oil filter inspection, Chapter 05-20-00.

d06867.fm

SERVICE INSTRUCTION - PAC

ENVIRONMENTAL NOTE

Be careful that no oil enters the sewerage system or the soil.
Collect waste oil and take it to the recycling center.

⚠ WARNING

Use appropriate protective gear. Used oil contains many harmful contaminants. The tool's cutting wheel and cut filter edges are sharp.

Step	Procedure
1	Allow the used oil filter to drain.
2	Place the square handle of the oil filter cutting tool (1) securely in a vice.
3	Screw the oil filter onto the tool.

1) Oil filter cutting tool
part no. 276270

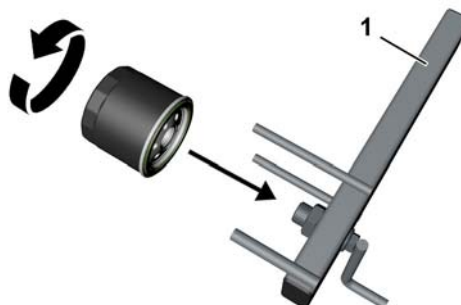

Fig. 3

10358

Step	Procedure
4	Place the cutter arm onto the single, large post (2).
5	Align the cutting wheel approx. 2 mm (0.078 in.) from the crimped edge of the black can (3).
6	Rotate the handle clockwise while gently applying downward pressure on the arm.

d06867.fm

SERVICE INSTRUCTION - PAC

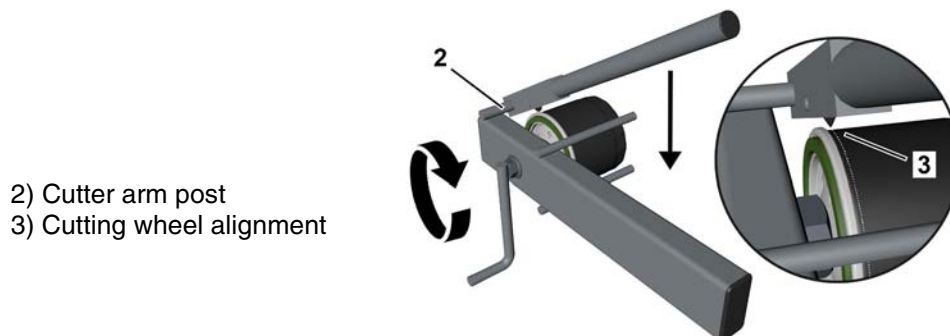

- 2) Cutter arm post
- 3) Cutting wheel alignment

Fig. 4

10359

Step	Procedure
7	Once the can has been cut through, carefully remove the can, filter and arm from the tool.
8	Inspect oil filter components following current Maintenance Manual Line (MML) for the respective engine type, Chapter 12-20-00.

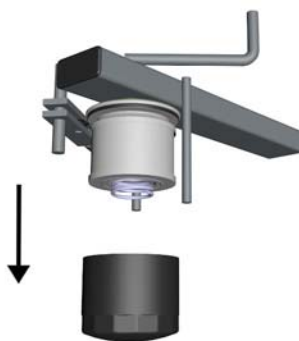

Fig. 5

10360

3.5) Maintenance (Heavy) - related information



See current Maintenance Manual Heavy (MMH) for the respective engine type for heavy maintenance procedures, such as oil change and oil filter inspection, Chapter 72-20-00.

d06867.fm

SERVICE INSTRUCTION - PAC

3.6) Test run

In case of uninstalled engines test run can be skipped as this is covered by the mandatory test run after installation.



Conduct test run and perform leakage check. See current Maintenance Manual Line (MML) for the respective engine type, Chapter 12-20-00.

3.7) Summary

The execution of the Service Instruction - PAC must be confirmed in the logbook.

| A revision bar outside of the page margin indicates a change to text or graphic.

Translation into other languages might be performed in the course of language localization but does not lie within ROTAX' scope of responsibility.

In any case the original text in English language and the metric units are authoritative.

3.8) Inquiries

Inquiries regarding this Service Instruction - PAC should be sent to the ROTAX® Authorized Distributor of your area.

A list of all ROTAX® Authorized Distributors or their independent Service Centers is provided on www.FLYROTAX.com.

NOTE: The illustrations in this document show the typical construction. They may not represent full detail or the exact shape of the parts which have the same or similar function.

Exploded views are **not technical drawings** and are for reference only. For specific detail, refer to the current documents of the respective engine type.